

物有所值 **The best value for money**

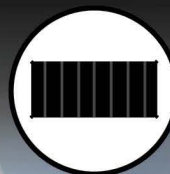

for

Complete solution in commercial vehicles parts and components

Customized & Standard



Roofs and pillars

- Sliding pillars
- Aluminium profiles

Body parts

- Load fixations
- Interior LED lamps
- Floor brackets

Tipplers and containers...

- Tipper locking
- Container corners
- Container locking gears
- Container twistlocks

Doors and Dropsides

- Locking gears
- Hinges

Protection and lights

- Rubber buffers
- Led lamps

Chassis parts

- Sideguard systems
- Mounting brackets
- Wheel carriers

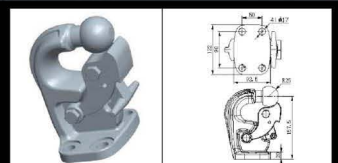

Ref.	Material	Height (mm)	L (mm)	Thickness (mm)	Weight (kg)
207744	/	92,5	187,5	122	/

Material annually shipped :

- 4000 tons of steel
- 1000 tons of rubber
- 800 tons of webbing
- 300 tons of aluminum
- 100 tons of PVC

Production processes :

- Routing / Drilling / Cutting
- Stamping / Bending / Die Casting
 - Laminating / Extrusion
 - Welding ...

Surface treatments :

- Raw with oil protection
- Zinc plated treatment / 48h
- Hot dip galvanised treatment / 500h
 - Zink flake coating / 500h
 - Black cathaphoresis / 400h
 - Epoxy / 300h
 - Anodisation ...

specific & standard truck parts

High quality standard of automotive manufacturing

Quality management

- Establish quality inspections guidelines
- Do initial inspections for materials
- Arrange compliance test for initial samples
- Do production inspections
- Stay online for quality control, report quality issues
- Drive corrective action plan
- Do pre-shipment inspections
- Chart and analyze factory's quality performance
- Do container loading check



With ITBC, **YOU** make the final decisions !

Our quality control

Product Specification and Quality Report				V2013
Ref : 113650		Last Update date : 01/11/2013		
1. PRODUCT DESCRIPTION				
Product Name: White Hinge				
Illustrations:				
Technical datas				
Characteristics				
Ref	Material 1	Material 2	Manufacturing process	
113650	Q235	Plastic	Stamping, welding, coating(zinc plated+powder), Assembly	
Illustration				
In the PQQR, the Standards for reference: ISO 9817, ISO 13920, ISO-10289, ISO 2768 mK				

Product Specification and Quality Report				V2013							
Ref : 113650		Last Update date : 01/11/2013									
Standards (According to the process)				OK							
ISO 2768 mK											
Critical Dimensions											
Dim	Expected Result	Measured value									
		1	2	3	4	5	6	7	8	9	10
A	Ø12 ± 0.2	Ø12.15	Ø12.18	Ø12.19	Ø12.04	Ø12.06	Ø12.17	Ø12.14	Ø12.18	Ø12.04	Ø12.19
B	Ø30 ± 0.5	Ø29.59	Ø29.60	Ø29.59	Ø29.50	Ø29.50	Ø29.85	Ø29.73	Ø29.58	Ø29.75	Ø29.67
C	39 ± 0.2	39.05	39.18	39.15	39.05	39.05	39.13	39.15	39.02	39.11	39.07
D	Ø10.5 ± 0.1	Ø10.47	Ø10.48	Ø10.58	Ø10.59	Ø10.46	Ø10.49	Ø10.41	Ø10.56	Ø10.54	Ø10.44
E	61 ± 0.1	61.03	61.03	61.05	61.09	60.99	60.97	60.99	61.08	60.97	61.00
F	150 ± 0.1	150.04	150.03	150.08	150.09	150.00	149.93	149.98	150.06	150.05	150.05
G	165 ± 0.1	165.02	165.08	165.08	164.93	164.92	164.99	165.01	165.06	165.00	165.07
Photos of measurement											
Other specifications											

Product Specification and Quality Report				V2013
Ref : 113650		Last Update date : 01/11/2013		
2. PACKING REQUIREMENTS				
a. Unit packing: 单元包装:				
Picture of unit packing:		Comments		
		1 plastic bag for 1 piece of part		
b. Inner packing: 内包装:				
Picture of inner packing:		Comments		
No inner packing		-		
c. Outer packing: 外包装:				
<input checked="" type="checkbox"/> Carton <input type="checkbox"/> Wooden box <input type="checkbox"/> Other:				
Quality of carton/pallet/wooden box must be according to ITBC packaging standard sheet				
Dim	Carton	Pallet(wooden box)		
Quantity	14 pcs/carton	1064 pcs/box		
size : L*W*H (mm)	380*200*140	1100*1000*970		
Weight (kg)	1.16	NW : 1234, GW : 1256		
Volume (m3)	0.011	1.21		
Photos				

- Each production batch inspected
- Quality Control reports on request at your disposal

From component design to delivery into your warehouse

Project management

- **ITBC** is coaching you through the three steps of the process, so that on your side formalities are made as easier as possible.
 - ✓ Product study
 - ✓ Sample / Prototype
 - ✓ Order and production

Logistics

- **ITBC** manages the transportation for you, from our manufacturing facilities to your final destination :
 - ✓ **ITBC** can join orders together with other already in process
 - ✓ **ITBC** sends your goods to your consolidation logistics center (CFS) in China
 - ✓ **ITBC** can manage your order in function of the status : **Sea, Train, Air** freight



The best value for money

ITBC Asia

Bastien Thomasset

Key Account Management

M +86 185 1665 2570

bastien.thomasset@itbc-ltd.com